

## GREAT BENTLEY XC RACE – HILLYFIELDS, COLCHESTER – 10 DECEMBER 2023

Great Bentley are hosting the 3rd fixture this season in the NESS XC League on 10/12/23 with an altered route around the country park.

### Venue, timings and distances

The venue is Hilly Fields, Sheepen Road, Colchester, CO3 3LL.

Entrance to the start/finish is at the corner of Sheepen Road opposite the school or via Sussex Road depending on where you park (please see below).

The juniors will race at 10am followed by the seniors racing at 10.45am.

The junior course starts and finishes on the field closest to the school with the race taking you through woods and on tracks and fields around the country park at Hilly Fields. The junior race is a single lap of 1.25 miles. A map is attached below.

The senior race comprises two laps of approx. 2.5 miles.

Please note that Hilly Fields is it is a country park and runners may encounter members of the public who are also using the park. Please be respectful to anyone on the course.

### Parking

**Please can we ask that as many as possible car share as this will help to ease congestion in the area and ensures that everyone gets parked up conveniently**

Parking will be as per last year, and there are two main parking options to access the race at Hilly Fields - Sheepen Road or Sussex Road. Sheepen Road is the closest. Parking options are set out on the attached map.

### **SHEEPEN ROAD**

#### **Post code Sheepen Road CO3 3LL**

There is road side parking permitted on Sundays on Sheepen Road. We will have marshals in place to guide vehicles. Please follow their instructions and park carefully so that we can get as many cars parked up at no cost. Note that we can only park along one side of the road to avoid causing road blockages.

Once all the road side parking is filled up, there is Sheepen Road car park. This costs £2.50 and can be paid for using the MiPermit app or via text message.

You can download the MiPermit app from the Apple App Store or the Google Play Store.

The location number for Sheepen Road car park is 737824.

To pay by text: send an SMS (text) message or call to pay. If you are paying through SMS message, text the word 'PARK' followed by your registration number and the duration of your stay to 61600. For example: 'PARK T123EST 30mins' or 'PARK T123EST 2hrs'.

Alternatively, call 0345 520 7007 from your mobile. Calls cost the standard rate as set by your mobile provider.

## **PARKING FROM SUSSEX ROAD (ACCESSED FROM LEXDEN ROAD)**

**There is also roadside parking available off Lexden Road.** Depending where you stop this will mean a 10 to 15 minute walk to the start field. Hilly Fields can be accessed from Sussex Road but please do not try to park there: spaces are extremely limited and it is difficult to turn around to get out.

Please park considerately and ensure that all driveways are left clear and that traffic is not impeded. Roads that can be parked on are: Park Road CO3 3UL; Queens Road CO3 3NY; The Avenue CO3 3PA; West Lodge Road CO3 3NL; Victoria Road CO3 3NT; Creffield Road CO3 3JA; Oxford Road CO3 3HN; Sussex Road CO3 3QJ.

## **ADDITIONAL PARKING**

There is also parking at **St Marys multi storey car park. CO3 3AA** . This is about half a mile from Hilly Fields. It is the most expensive option and costs over £4 per vehicle. The entrance to this car park could become congested with Sunday shoppers! Parking is by way of coins or MiPERMIT App. There will be marshals to guide participants down to Hilly Fields. Walk along the front of the building to Popes Lane. Follow the marshal's directions down to the run.

## [Refreshments and toilets](#)

Toilets are available at St Helena School which is opposite the Sheepen Road entrance to Hilly Fields. Please note we do not have full access to the school so ideally changing to be done outside by cars or on the main field.

Refreshments will also be available in the school playground.

In true GBRC tradition we will be having a cake table and hot drinks and ask that donations be made which will be given to charity. This year we will be supporting *Run for Gem* and funds raised will be passed on to St Helena's Hospice and Brain Tumour Research in memory of Gemma Edgar, a local runner who passed away 5 years ago.

## [Results and score sheets](#)

Score sheets are to be handed in to the gazebo near the start/finish area. Each club will be provided with a plastic wallet, please place finishing tokens and your score sheets in the wallet. Results will be announced as soon as possible after the end of the race.

## [Payment of race fees](#)

Race fees are to be paid to the League account:

Sort Code: 30-99-50

A/C No: 60695760

A/C Name: North Essex and Suffolk Cross Country League

Fees for each club will be confirmed alongside the results and will be £4 per senior runner (juniors run for free).

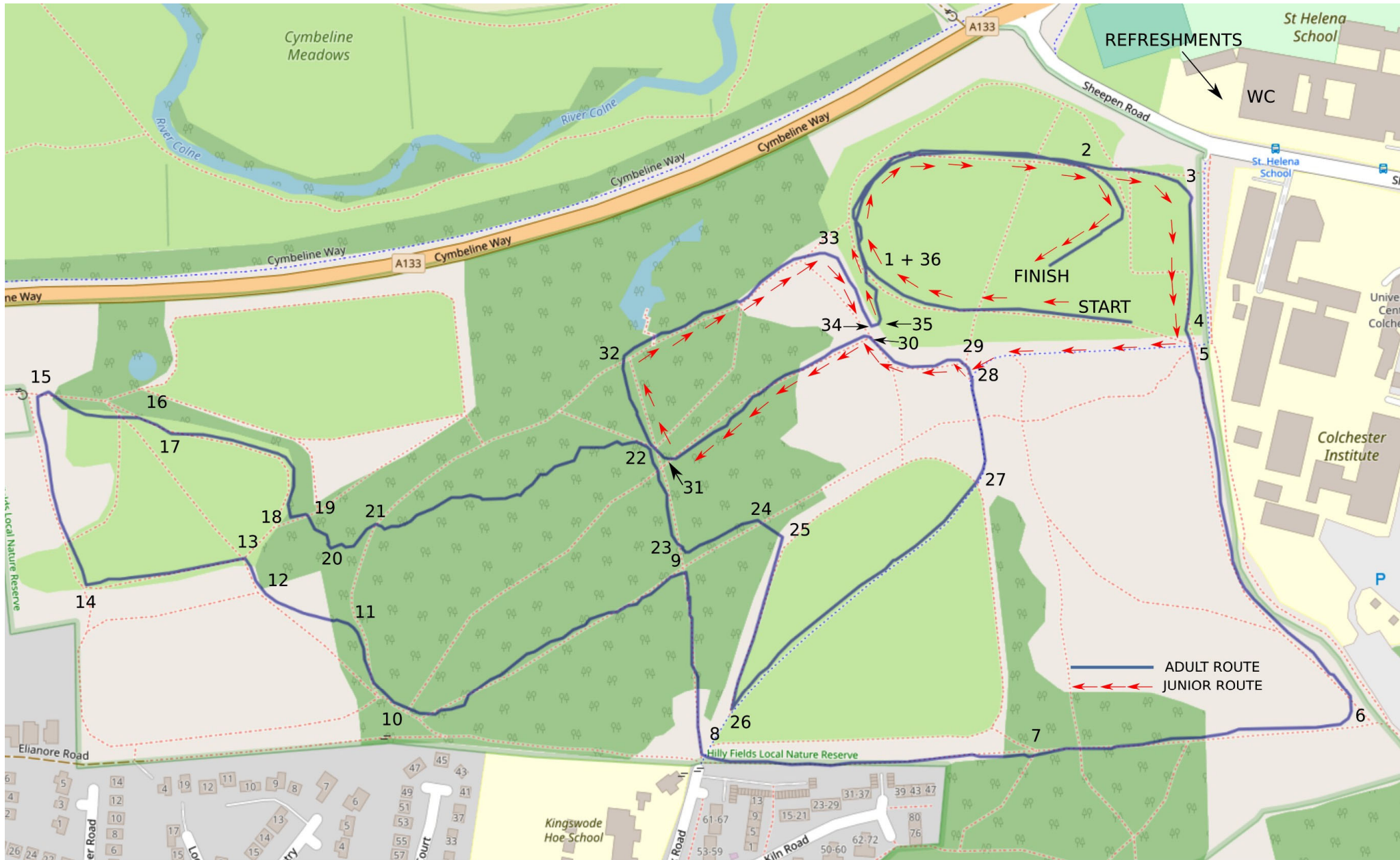

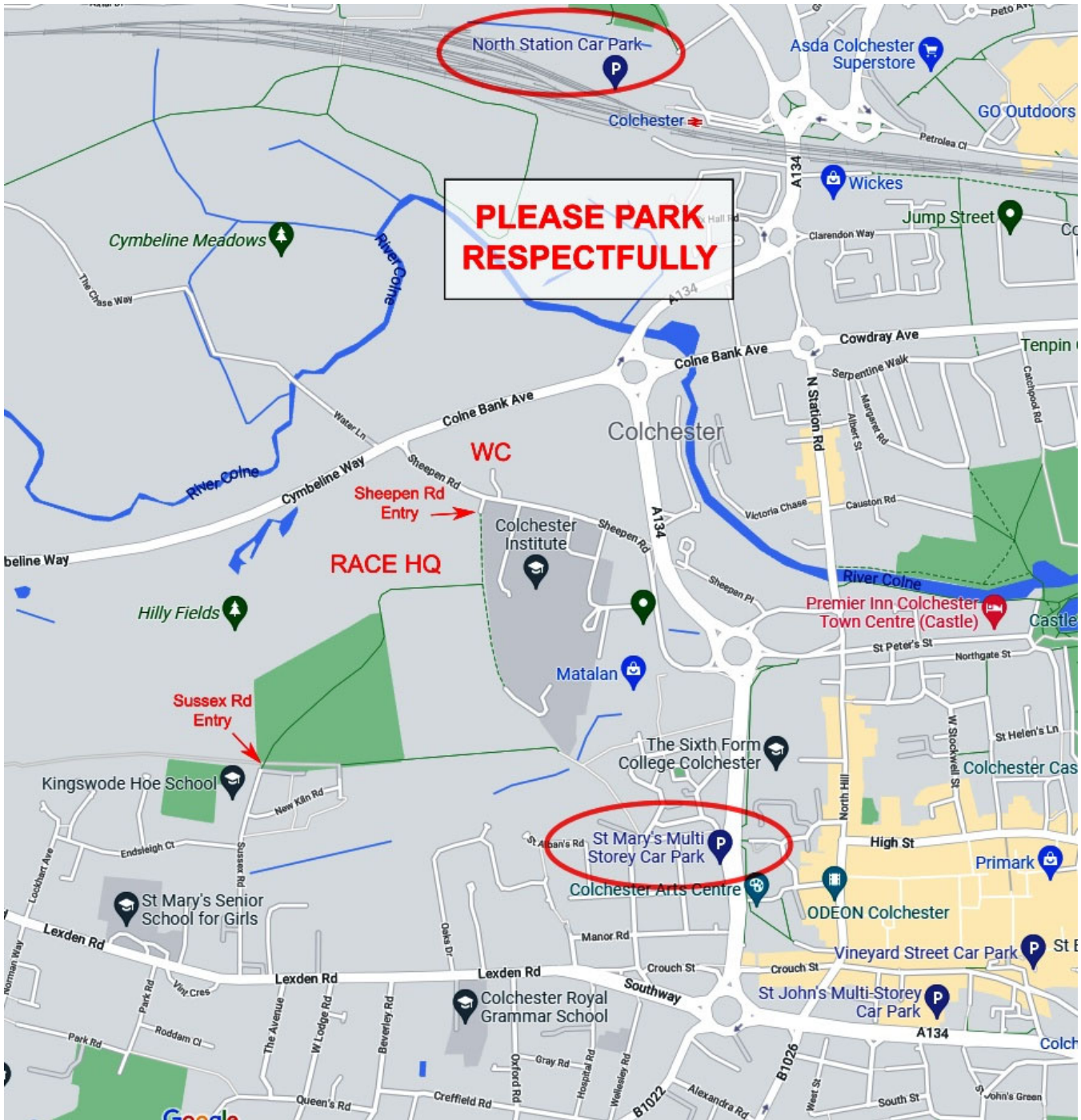

North Station Car Park

**PLEASE PARK  
RESPECTFULLY**

**RACE HQ**  
**WC**

Sussex Rd  
Entry

St Mary's Multi  
Storey Car Park